

Unit Plan

FLAT B | 2B 1T

Tower I & J

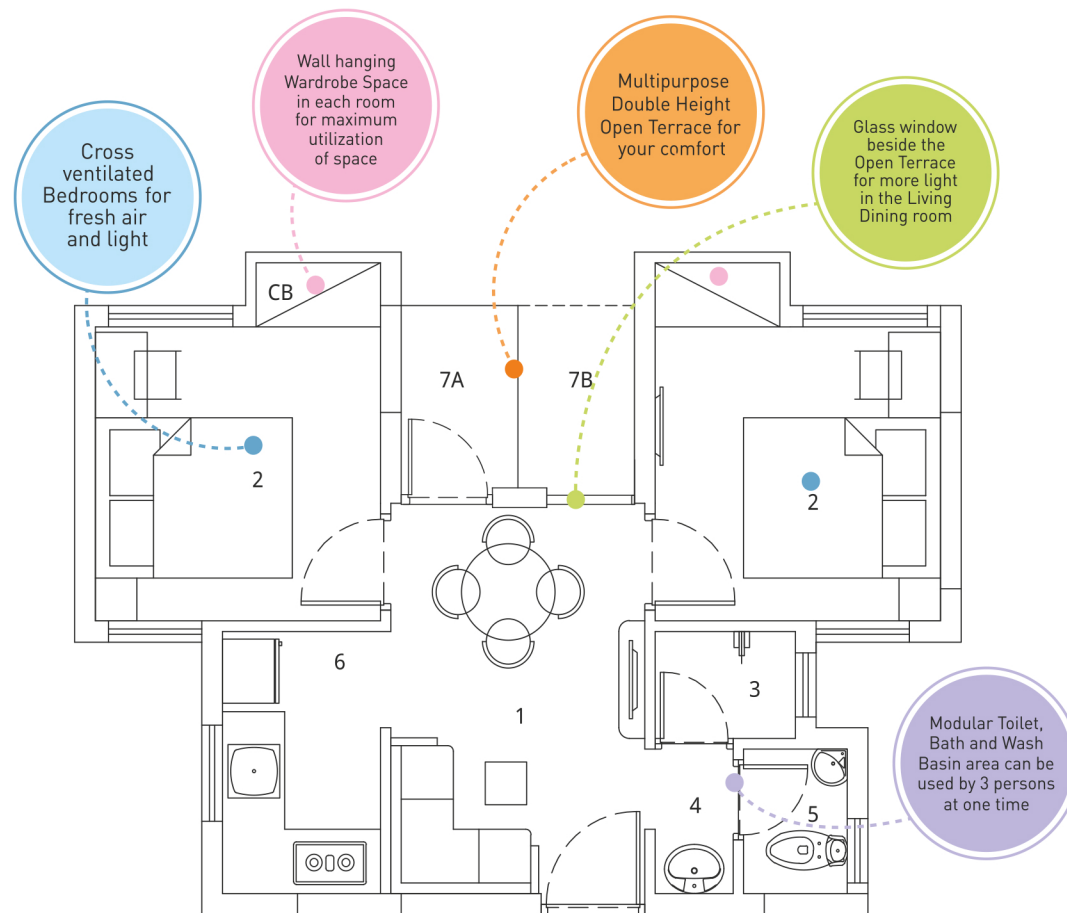

Carpet area 369 sq ft
Built up area 446 sq ft
Standard built up area 620 sq ft

1	Living/Dining	8'0"x12'0"
2	Bedroom	11'0"x9'0" (9'0"x9'0" without CB)
3	Bathroom	4'5"x3'3"
4	WC	3'3"x4'5"
5	Basin	4'5"x2'6"
6	Kitchen	5'0"x8'0"
7A*	Open terrace	3'8"x5'5"
7B*	Open terrace	3'8"x5'5"